

BODY MARK

1/2
CF8M
200
WARREN
→

Fig No: **WARREN-222**

MATERIAL LIST

NO.	PART NAME	MATERIAL	Q'TY
		STAINLESS STEEL	
1	BODY	ASTM A351-CF8M	1
2	CAP	ASTM A351-CF8M	1
3	STEM	AISI SS316	1
4	DISC	AISI SS316	1
5	GLAND	AISI SS316	1
6	GASKET	PTFE	1
7	PACKING	PTFE	1SET
8	WASHER (2)	AISI SS316	1
9	GLAND NUT	ASTM A351-CF8M	1
10	HANDLE WHEEL	ADC 12	1
11	WASHER (1)	AISI SS304	1
12	HANDLE WHEEL NUT	AISI SS304	1
13	NAME PLATE	ALUMINUM	1

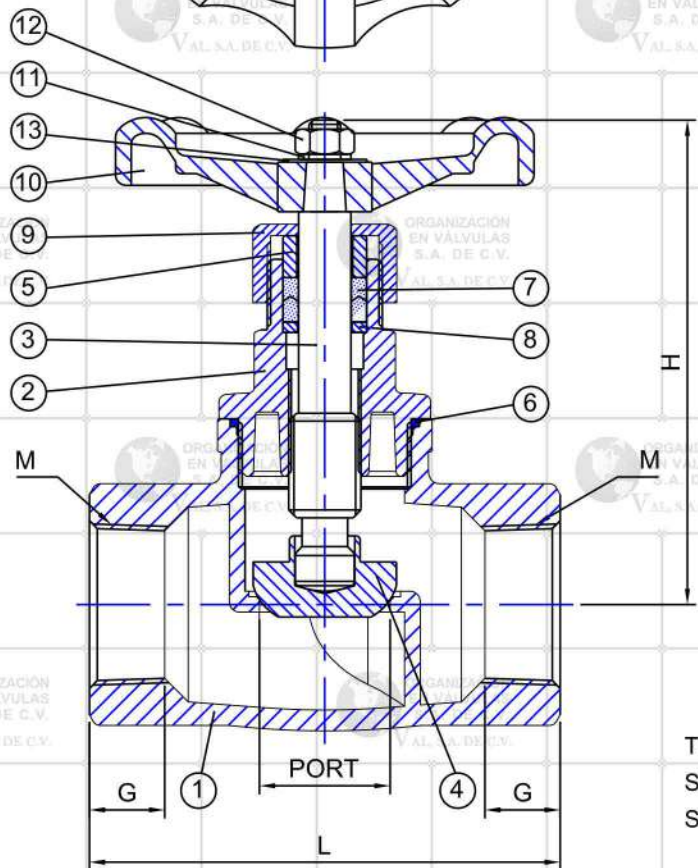

DIMENSIONS

unit:inch

SIZE	PORT	L	G	H		W	M	CV(GPM)	TORQUE(LBF-IN)	WEIGHT(LBS)	
				OPEN	CLOSE						
DN15	1/2"	0.59	2.59	0.47	3.88	3.59	2.76	NPT	3.2	150.47	0.97
DN20	3/4"	0.79	2.93	0.55	4.03	3.58	2.76	NPT	5.9	150.47	1.45
DN25	1"	0.98	3.54	0.57	4.35	3.74	3.15	NPT	8.9	177.02	1.90
DN32	1-1/4"	1.26	4.20	0.70	5.07	4.36	3.15	NPT	15	221.28	2.69
DN40	1-1/2"	1.57	4.70	0.72	5.76	4.97	3.94	NPT	27	318.64	4.01
DN50	2"	1.97	5.47	0.88	6.34	5.48	3.94	NPT	41	398.3	5.56

TEST PRESSURE:
Shell (by Water), 300 Psig
Seat (by Air), 80 Psig

APPLICABLE STANDARDS:
NPT Threads To ANSI B 1.20.1



APPROVED BY.	CHECK BY.	DRAWN BY.	DRAWINGNO.	MATERIAL	UNIT	DESCRIPTION
SIGN	CHANG	PETER CHEN	WARREN-222	ASTM A351-CF8M	INCH	STAINLESS STEEL GLOBE VALVES, THREADED END, 200 WOG
DATE	05/02/2012	05/02/2012	REVISION	SCALE	FREE	