

BODY MARK  
(EXAMPLE)

WARREN  
2  
300  
CF8M

TEST PRESSURE :

Shell ( by Water ) ,1100 Psig  
Seat ( by Water ) ,792 Psig  
( by Air ) ,80 Psig

APPLICABLE STANDARDS :

Gate Valve : API 603  
Shell Wall Thickness : ANSI B16.34  
Face to Face : ANSI B16.10  
End Flanges : ANSI B16.5  
Test Inspection Per API 598  
NACE MR 01-75  
Low Emission : ISO 15848-2 50 PPM

# Fig No: WARREN-1306

## MATERIALS LIST

NO.	NAME PARTS	MATERIALS
1	BODY	ASTM A351 Gr.CF8M
4	WEDGE	ASTM A351 Gr.CF8M (FLEXIBLE WEDGE)
5	STEM	ASTM A276 Gr.316
9	BONNET	ASTM A351 Gr.CF8M
11	GASKET	S.S SPIRAL WOUND+PTFE / GRAPHITE
12	SEAT	STL#6 (10" & ABOVE)
14	PACKING	PTFE(CUP&CONE DESIGN) / GRAPHITE(FLAT DESIGN)
15	GLAND	ASTM A351 Gr.CF8M
16	EYE BOLT NUT	ASTM A194 Gr.8MA (HEAVY)
18	SLEEVE	ASTM A439 Gr.D2C
18-1	YOKE	ASTM A351 Gr.CF8 (10" & ABOVE)
19	HANDWHEEL	ASTM A536 DUCTILE IRON
20	SET SCREW	ASTM A193 Gr.B8
22	STEM NUT	ASTM A351 Gr.CF8 (1-1/2" & ABOVE)
23	WASHER	ASTM A276 Gr.304 (1" & UNDER)
24	HANDWHEEL NUT	ASTM A351 Gr.CF8
25	NAME PLATE	ASTM A666 Gr.304
25-1	LOW EMISSION NAMEPLATE	ASTM A666 Gr.304
35	BONNET STUD	ASTM A193 Gr.B8MA (10" & UNDER) ASTM A193 Gr.B8M CLASS 2 (12" & ABOVE)
35-1	YOKE BOLT	ASTM A193 Gr.B8MA (10") ASTM A193 Gr.B8M CLASS 2 (12" & ABOVE)
37	BONNET NUT	ASTM A194 Gr.8MA (10" & UNDER) ASTM A194 Gr.8M (12" & ABOVE)
37-1	YOKE NUT	ASTM A194 Gr.8MA (10") ASTM A194 Gr.8M (12" & ABOVE)
40	EYE BOLT	ASTM A193 Gr.B8MA
47	GLAND FLANGE	ASTM A351 Gr.CF8
48	EYE BOLT PIN	ASTM A276 Gr.304
53	GREASE FITTING	ANSI 304 (1-1/2" & ABOVE)
56	BEARING	STEEL (10" & ABOVE)

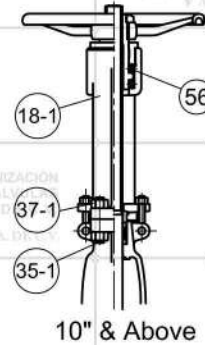
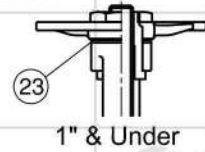
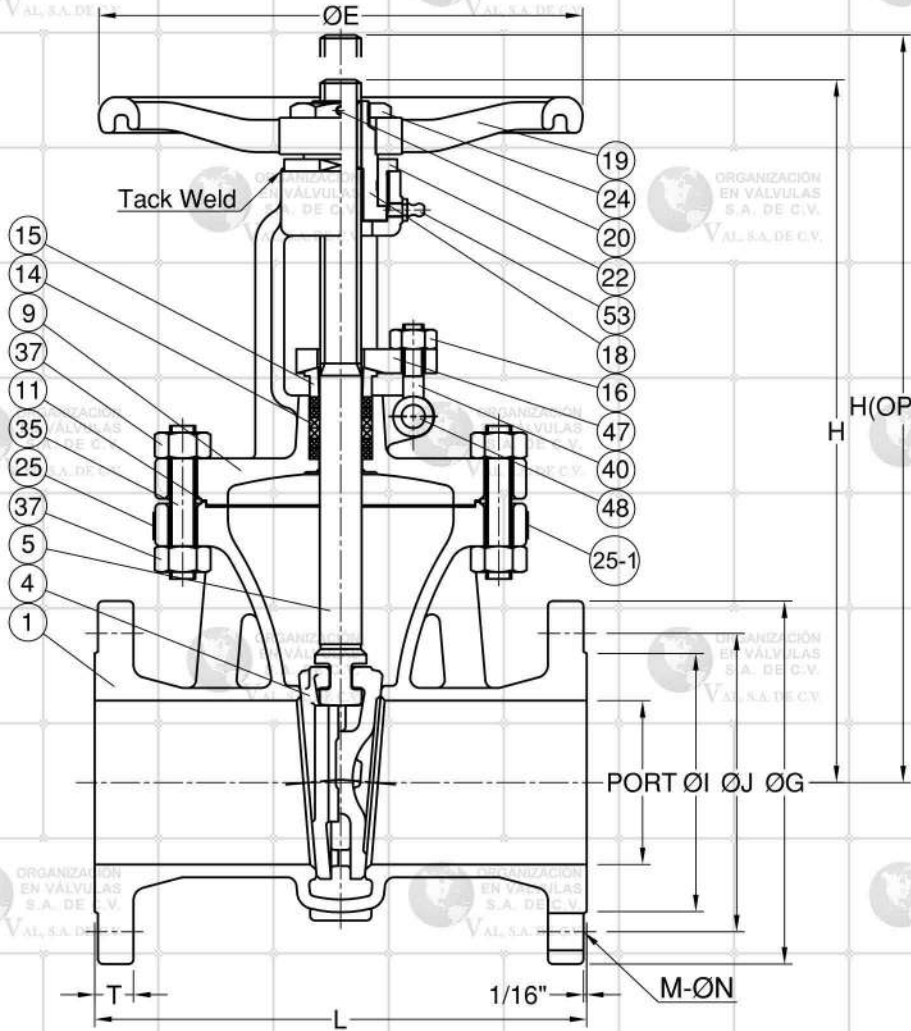

## DIMENSIONS

SIZE	PORT	L	ØE	H	H(OPEN)	ØG	ØJ	ØI	T	M	ØN	Weight(lbs)	Torques (lb-in)	CV's (GPM)	
DN15	1/2"	0.59	5.50	3.94	7.20	7.91	3.75	2.62	1.38	0.56	4	0.62	8.8	51	16.08
DN20	3/4"	0.75	6.00	3.94	7.95	8.86	4.62	3.25	1.69	0.62	4	0.75	12.3	59	37.61
DN25	1"	1.00	6.50	5.91	9.41	10.55	4.88	3.50	2.00	0.69	4	0.75	19.2	73	69.70
DN40	1-1/2"	1.50	7.50	7.87	10.55	12.24	6.12	4.50	2.88	0.81	4	0.88	33.1	109	164.13
DN50	2"	2.00	8.50	7.87	11.85	14.17	6.50	5.00	3.62	0.88	8	0.75	39.2	135	306.77
DN65	2-1/2"	2.50	9.50	7.87	13.15	16.02	7.50	5.88	4.12	1.00	8	0.88	63.9	169	492.46
DN80	3"	3.11	11.12	11.81	14.49	17.91	8.25	6.62	5.00	1.12	8	0.88	86.6	235	709.14
DN100	4"	4.00	12.00	11.81	17.17	21.57	10.00	7.88	6.19	1.25	8	0.88	123.5	457	1297.24
DN150	6"	6.00	15.88	13.78	24.02	30.59	12.50	10.62	8.50	1.44	12	0.88	246.9	1236	3107.30
DN200	8"	8.00	16.50	15.75	29.57	38.07	15.00	13.00	10.62	1.62	12	1.00	401.2	2337	5717.97
DN250	10"	10.00	18.00	17.72	35.71	46.42	17.50	15.25	12.75	1.88	16	1.12	617.3	3783	8934.33
DN300	12"	12.00	19.75	17.72	41.54	54.29	20.50	17.75	15.00	2.00	16	1.25	864.2	5698	13351.10
DN350	14"	13.25	30.00	21.65	48.20	62.28	23.00	20.25	16.25	2.12	20	1.25	1342	8138	16277.45
DN400	16"	15.25	33.00	23.62	51.93	67.91	25.50	22.50	18.50	2.25	20	1.38	1705	13919	21562.26
DN450	18"	17.25	36.00	24.02	57.44	77.13	28.00	24.75	21.00	2.38	24	1.38	2794	18285	27889.03
DN500	20"	19.25	39.00	24.02	63.54	86.38	30.50	27.00	23.00	2.50	24	1.38	3080	23425	34837.16

**warren Valve**

	APPROVED BY.	CHECK BY.	DRAWN BY.	DRAWINGNO.	MATERIAL	UNIT	DESCRIPTION
SIGN	William.Wang	S.C.Chen	Kiko.Wen	WARREN-1306	MATERIAL LIST	inch	STAINLESS STEEL GATE VALVES
DATE	08/18/2015	08/18/2015	08/18/2015	REVISION 12	SCALE	FREE	FLANGED END ANSI CLASS 300